



REDLINE® V 300/4

Shut-off valve

Description

V 300/4 is a diaphragm shut-off valve with position indicator and click function. It is especially suitable for non-corrosive gases up to 6.0 purity (99.9999%) as well as gas mixtures with a low concentration of corrosive components. The V300/4 is available in the variant 3110 (three inputs and one output) or 1130 (one input and three outputs).

Product name	Material	bar	psi	Art. Nr
Version with three inputs and one output				
V 300/4_3110	Chrome-plated brass	300	4351	7776
V 300/4_3110	Stainless steel	300	4351	7777
Version with one input and three outputs				
V 300/4_3110	Chrome-plated brass	300	4351	7780
V 300/4_3110	Stainless steel	300	4351	7781

Delivery and ordering information

Diaphragm shut-off valve including particle filter without inlet and outlet screw connection. In addition to the article number, please specify the type of gas. Other configurations on request.

Benefits

V 300/4 is used as a shut-off valve in a central gas supply system. The click function ensures a clear closed position and prevents over-turning.

Technical Data

	bar	psi
Maximum primary pressure	300	4351
Gas purity	≤ 6.0 (99.9999%)	
Leak rate	≤10 ⁻⁹ mbar l/s He to the outside ≤5x10 ⁻⁶ mbar l/s He in the seat	
Connections		
- Inlet	NPT ¼" f	
- Outlet	NPT ¼" f	
Flow coefficient	Cv = 0.29 – Kv = 0.25	
EX Zones	Meets the requirements of ISO 80079-36, IEC TS 60079-32-1 and the German TRGS 727. Can be used in Ex zones 1 and 2 for gases with explosion risk of group I, IIA, IIB, IIC	
Materials		
- Casing	Cr-plated brass	Stainless steel 316L
- Membrane	Hastelloy®	1 x Elgiloy®
- Seat seal	PCTFE	
Operating temperature	-20°C ... +60°C	-4°F ... +140°F
Particle filter	Inlet 100 µm Outlet 100 µm	
Weight	0.63 kg max.	1.39 lb max.
Suitable for vacuum	Yes	

Other accessories

Gas type-specific manual connection, brass or stainless-steel compression fittings from 3 to 12 mm or 1/8" to 1/2" for service gas and relief valve outlet, contact pressure gauge.

Quality Assurance

The diaphragm shut-off valve V 300 is manufactured, tested and delivered in accordance with the following international standards: ISO 900 and EN ISO 10297. The chrome-plated brass version is suitable for oxygen applications.



V 300/4

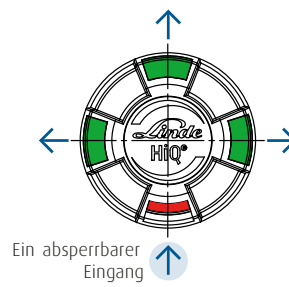
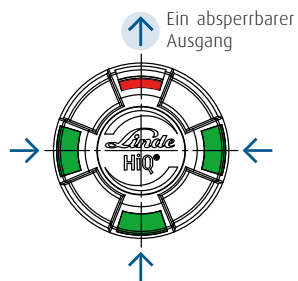
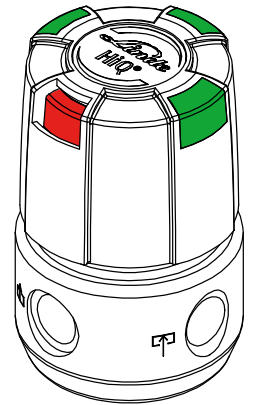
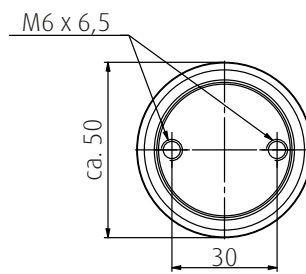
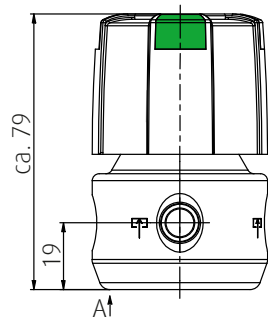

All dimensions in millimeters

V 300/4

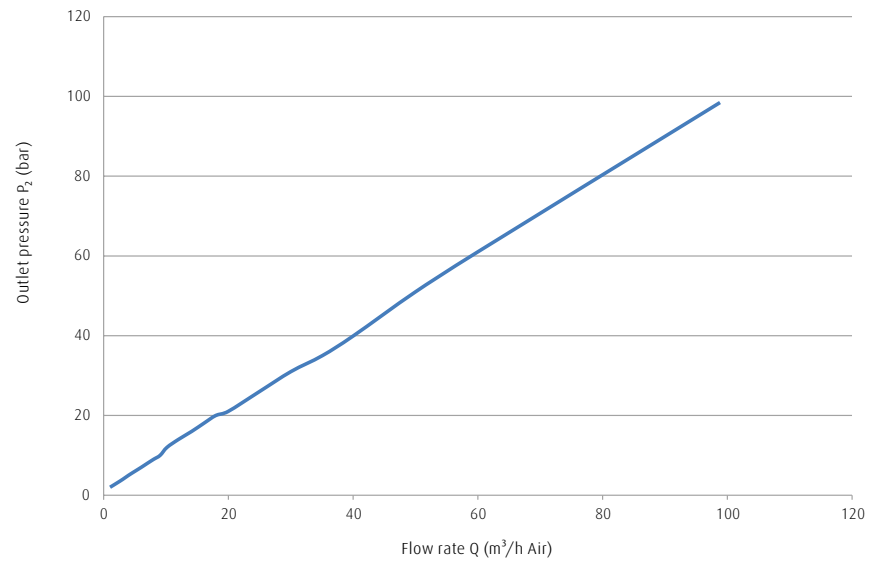

Linde GmbH
Dr.-Carl-von-Linde-Strasse 6-14, 82049 Pullach, Germany
Phone +49 89 7446-0, Fax +49 89 7446-1230, <http://hiq.linde-gas.com>